

ELAN IMPRESSION 50

P & B (2015)

The Sailing yacht Elan Impression 50 P & B homeport is ACI Marina Split, Croatia. Built in 2015, and accommodates up to 10 + 2 persons in 5 + 1 cabins, and has 2 + 1 heads.

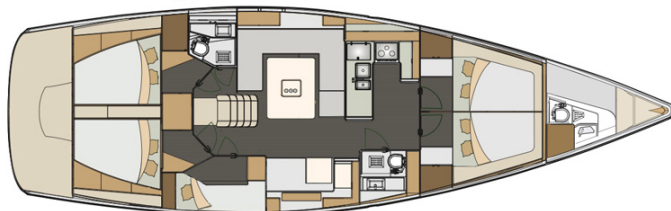

YACHT SPECIFICATIONS

Charter base

ACI Marina Split, Croatia

Yacht ID

840

Brands

Elan Marine

Name

P & B

Production year

2015

Length

50 ft

Cabins

5 + 1

Berths

10 + 2

Head/Shower

2 + 1

Engine

1 x 75 HP

Fuel tank

295 l

SECRET  ADRIATIC

WEBSITE

www.secret-adriatic.com

E-MAIL

info@secret-adriatic.com

PHONE

+385 (0)91 2106 996

SECRET ADRIATIC D.O.O.

Put Mavarčice 1/a, Okrug Gornji, Croatia

YACHT EQUIPMENT

Comfort	Cockpit cushions, Deck cushions
Deck	Bathing platform, Bimini top, Boat hook, Cockpit fridge, Cockpit table, Cockpit/stern, outside shower, Dinghy, Dinghy (byboat) pump, Electric anchor windlass, Fenders, Gangway, Main anchor, Mooring ropes , Spare anchor (Reserve, Auxiliary anchor), Sprayhood, Teak cockpit
Entertainment	Outdoor speakers, Radio CD player + USB, TV + DVD
Galley	Coffee machine, Gas bottles, Hot water, Kitchen utensils (Galley equipment, cutlery), Oven, Refrigerator
Interior	Ambiental lighting
Navigation	Autopilot, Binoculars, Bow thruster, Compass, GPS chart plotter - cockpit, Hand bearing compass, Harbour guides, Log/speed instrument, Navigation (Nautical) charts and nautical guide , Windex
Safety	Emergency tiller, First aid kit , Liferaft , Oars (Paddles), Safety equipment, VHF radio
Yacht electrics	12V Socket, Air Conditioning, Battery charger , Shore connection 220 V, Solar panels

SERVICES

EXTRA SERVICES	OBLIGATORY	PAYMENT TYPE	PRICE
Charter pack <i>(Payable in the base)</i> Price per week / Season: 2026. WEEK: Includes transitlog, Internet hot spot (25 GB, 15 connections), outboard engine + fuel, bed linen, 2 towels per person, 2 kitchen towels; Surcharge per every additional week, if no cleaning between the weeks is required: 90 €	No	per booking	400,00 €
Deposit insurance <i>(Payable in the base)</i> Price per week / Season: 2026. + 400 EUR refundable part (150 EUR franchise non-refundable in case of damage +250 EUR deposit in case of fuel shortage ,late arrival, toilet declogging, full black tanks upon return and marina fees). This deposit insurance can be applied to only one skipper and cannot be applicable to another skipper if they change during one chartered booking. The cost is to be paid in cash.	No	per booking	400,00 €
Early Check in <i>(Payable in the base)</i> Price per week / Season: 2026. at 13:30h	No	per booking	150,00 €
Fun Package <i>(Payable in the base)</i> Price per week / Season: 2026. SUP + 4 snorkelling sets	No	per week	145,00 €
Hostess <i>(Payable in the base)</i> Price per week / Season: 2026.	No	per day + food	190,00 €
Internet hotspot <i>(Payable in the base)</i> Price per week / Season: 2026. 25 GB, up to 15 connections	No	per week	30,00 €
Linnen exchange <i>(Payable in the base)</i> Price per week / Season: 2026.	No	per set	12,00 €
Pet on board <i>(Payable in the base)</i> Price per week / Season: 2026. upon request	No	per booking	120,00 €
Provisioning <i>(Payable in the base)</i> Price per week / Season: 2026. + cost of food	No	per service	30,00 €

Skipper <i>(Payable in the base)</i>	No	per day + food	220,00 €
Price per week / Season: 2026. Payable directly to skipper + provide food for the skipper			
Transfer <i>(Payable in the base)</i>	No	one-way	75,00 €
Price per week / Season: 2026. APT Split - ACI Split (8 pax)			
Transit log <i>(Payable in the base)</i>	Yes	per booking	220,00 €
Price per week / Season: 2026.			

OPTIONAL EXTRAS

EXTRAS	OBLIGATORY	PAYMENT TYPE	PRICE
Beach towel <i>(Payable in the base)</i> Price per week / Season: 2026. <i>Payable in the base</i>	No	per piece	10,00 €
Coffee capsules <i>(Payable in the base)</i> Price per week / Season: 2026. <i>Price upon request - Payable in the base</i>	No	per booking	0,00 €
Gennaker <i>(Payable in the base)</i> Price per week / Season: 2026. <i>+ 500 EUR deposit - Payable in the base</i>	No	per week	250,00 €
Kayak <i>(Payable in the base)</i> Price per week / Season: 2026. <i>Payable in the base</i>	No	per week	200,00 €
Outboard engine <i>(Payable in the base)</i> Price per week / Season: 2026. <i>Payable in the base</i>	No	per week	80,00 €
Railing net (Safety net) <i>(Payable in the base)</i> Price per week / Season: 2026. <i>Payable in the base</i>	No	per booking	200,00 €
Snorkeling equipment <i>(Payable in the base)</i> Price per week / Season: 2026. <i>Payable in the base</i>	No	per set	15,00 €
Stand up paddle (SUP) <i>(Payable in the base)</i> Price per week / Season: 2026. <i>Payable in the base</i>	No	per week	110,00 €
Towels <i>(Payable in the base)</i> Price per week / Season: 2026. <i>2 piece, 1 large 1 medium sized - Payable in the base</i>	No	per person	10,00 €

PRICE AND AVAILABILITY

13.09. - 20.09.2025 BOOKED	20.09. - 27.09.2025 BOOKED	27.09. - 04.10.2025 BOOKED	04.10. - 11.10.2025 1.918 € 2.950€
11.10. - 18.10.2025 2.213 € 2.950€	18.10. - 25.10.2025 2.213 € 2.950€	25.10. - 01.11.2025 2.213 € 2.950€	01.11. - 08.11.2025 2.213 € 2.950€
08.11. - 15.11.2025 2.213 € 2.950€	15.11. - 22.11.2025 2.213 € 2.950€	22.11. - 29.11.2025 2.213 € 2.950€	29.11. - 06.12.2025 2.213 € 2.950€
06.12. - 13.12.2025 2.213 € 2.950€	13.12. - 20.12.2025 2.213 € 2.950€	20.12. - 27.12.2025 2.213 € 2.950€	03.01. - 10.01.2026 2.900 €
10.01. - 17.01.2026 2.900 €	17.01. - 24.01.2026 2.900 €	24.01. - 31.01.2026 2.900 €	31.01. - 07.02.2026 2.900 €
07.02. - 14.02.2026 2.900 €	14.02. - 21.02.2026 2.900 €	21.02. - 28.02.2026 2.900 €	28.02. - 07.03.2026 2.900 €
07.03. - 14.03.2026 2.900 €	14.03. - 21.03.2026 2.900 €	21.03. - 28.03.2026 2.900 €	28.03. - 04.04.2026 2.900 €
04.04. - 11.04.2026 2.900 €	11.04. - 18.04.2026 2.900 €	18.04. - 25.04.2026 2.610 € 2.900€	25.04. - 02.05.2026 2.610 € 2.900€

PRICE AND AVAILABILITY

02.05. - 09.05.2026 2.610 € 2.900€	09.05. - 16.05.2026 2.970 € 3.300€	16.05. - 23.05.2026 2.475 € 3.300€	23.05. - 30.05.2026 3.000 € 4.000€
30.05. - 06.06.2026 3.375 € 4.500€	06.06. - 13.06.2026 3.713 € 4.950€	13.06. - 20.06.2026 3.713 € 4.950€	20.06. - 27.06.2026 3.938 € 5.250€
27.06. - 04.07.2026 3.938 € 5.250€	04.07. - 11.07.2026 3.938 € 5.250€	11.07. - 18.07.2026 4.088 € 5.450€	18.07. - 25.07.2026 4.088 € 5.450€
25.07. - 01.08.2026 4.088 € 5.450€	01.08. - 08.08.2026 4.088 € 5.450€	08.08. - 15.08.2026 3.938 € 5.250€	15.08. - 22.08.2026 3.938 € 5.250€
22.08. - 29.08.2026 3.525 € 4.700€	29.08. - 05.09.2026 3.525 € 4.700€	05.09. - 12.09.2026 3.150 € 4.200€	12.09. - 19.09.2026 2.663 € 3.550€
19.09. - 26.09.2026 2.663 € 3.550€	26.09. - 03.10.2026 2.175 € 2.900€	03.10. - 10.10.2026 2.175 € 2.900€	10.10. - 17.10.2026 2.175 € 2.900€
17.10. - 24.10.2026 2.175 € 2.900€	24.10. - 31.10.2026 2.175 € 2.900€	31.10. - 07.11.2026 2.175 € 2.900€	07.11. - 14.11.2026 2.320 € 2.900€
14.11. - 21.11.2026 2.320 € 2.900€	21.11. - 28.11.2026 2.320 € 2.900€	28.11. - 05.12.2026 2.320 € 2.900€	05.12. - 12.12.2026 2.320 € 2.900€
12.12. - 19.12.2026 2.320 € 2.900€	19.12. - 26.12.2026 2.320 € 2.900€		