

# BALI 4.2

Hubble (2022)

The Catamaran Bali 4.2 Hubble homeport is Marina Šangulin, Biograd, Croatia. Built in 2022, and accommodates up to 8 + 2 + 1 persons in 4 + 1 cabins, and has 4 + 1 heads.

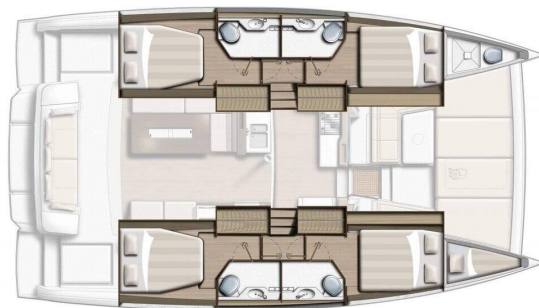

## YACHT SPECIFICATIONS

Charter base

**Marina Šangulin, Biograd, Croatia**

Yacht ID

**7709**

Brands

**Catana Group**

Name

**Hubble**

Production year

**2022**

Length

**42 ft**

Cabins

**4 + 1**

Berths

**8 + 2 + 1**

Head/Shower

**4 + 1**

Engine

**2 x 45 HP**

Fuel tank

**600 l**

SECRET  ADRIATIC

WEBSITE

[www.secret-adriatic.com](http://www.secret-adriatic.com)

E-MAIL

[info@secret-adriatic.com](mailto:info@secret-adriatic.com)

PHONE

+385 (0)91 2106 996

SECRET ADRIATIC D.O.O.

Put Mavarčice 1/a, Okrug Gornji, Croatia

## YACHT EQUIPMENT

|                 |   |
|-----------------|---|
| Comfort         | Bed linen, Cockpit cushions, Outside cushions, Pillows, Sundeck cushions  |
| Deck            | Anchor, Bilge pump - Mechanic, Boat hook, Cockpit grill, Cockpit table, Cockpit/stern, outside shower, Dinghy, Electric anchor windlass, Fenders, Gangway, Hard Top Bimini, Mooring ropes , Spare anchor (Reserve, Auxiliary anchor), Sun deck, Water hose, Winch handles |
| Entertainment   | Fusion radio, Outdoor speakers, Wireless Internet Router  |
| Galley          | Electrical kettle, Gas bottles, Gas cookers, Kitchen utensils (Galley equipment, cutlery), Moka pot, Oven, Refrigerator, Sink   |
| Interior        | Carpet, Duvet cover, Electric toilet  |
| Navigation      | Autopilot, Binoculars, Compass, Divider, nautic chart, GPS chart plotter - cockpit, Hand bearing compass, Navigation (Nautical) charts and nautical guide , Navigation set, Radar reflector, Tridata, Wind instrument/Anemometer  |
| Safety          | Black Water Tank, Distress flare box, Emergency tiller, Fire extinguisher , First aid kit , Flashlight, Fog horn, Horseshoe lifebuoy, Life belts (Safety harness), Life jackets, Light and rope for horseshoe life buoy, Repair kit, Set of tools , VHF radio             |
| Sails           | Electric winch  |
| Yacht electrics | 12V Socket, 220V socket, Air Conditioning, Battery charger , Bilge pump - Electric, Heating, Inverter, Pump, Service batteries, Shore connection 220 V, Solar panels  |

## SERVICES

| EXTRA SERVICES   | OBLIGATORY | PAYMENT TYPE | PRICE           |
|--|------------|--------------|-----------------|
| <b>Assisted Sailing</b> <i>(Payable in the base)</i><br><b>Price per week / Season: 2026 - Angelina Yachtcharter.</b> <i>Valovie - remote sailing assistance; Our skipper will help and assist you remotely during your charter, and provide you advices when it comes to berths, restaurant recommendations, weather forecasts etc.</i>   | No         | per booking  | <b>270,00 €</b> |
| <b>Charter package</b> <i>(Payable in the base)</i><br><b>Price per week / Season: 2026 - Angelina Yachtcharter.</b> <i>Charter package includes final cleaning, gas, check-in and out services, Wi-Fi 70GB/week, package for toilets (toilet paper and soap /per each toilet) and kitchen (1 kitchen paper towels, a sponge and a cleaning cloth, a small package of dish detergent, 1 waste bag, 2 kitchen towels, 2x 1l bottle of water), bed linen/bath towels (2 sets per cabin - do not include saloon and skipper cabin).</i> | Yes        | per booking  | <b>400,00 €</b> |
| <b>Deposit insurance</b> <i>(Payable in the base)</i><br><b>Price per week / Season: 2026 - Angelina Yachtcharter.</b> <i>+ refundable deposit 300,00 EUR</i>  | No         | per booking  | <b>360,00 €</b> |
| <b>Pet on board</b> <i>(Payable in the base)</i><br><b>Price per week / Season: 2026 - Angelina Yachtcharter.</b> <i>maximum 2 pets allowed</i>  | No         | per booking  | <b>200,00 €</b> |
| <b>WiFi GRATIS ON BOAT</b> <i>(Payable in advance)</i><br><b>Price per week / Season: 2026 - Angelina Yachtcharter.</b> <i>GRATIS</i>  | Yes        | per booking  | <b>0,00 €</b>   |

## OPTIONAL EXTRAS

| EXTRAS   | OBLIGATORY | PAYMENT TYPE     | PRICE           |
|--|------------|------------------|-----------------|
| <b>Automatic Inflatable Life Jacket</b> <i>(Payable in the base)</i><br><b>Price per week / Season: 2026 - Angelina Yachtcharter.</b> <i>Payable in the base</i>   | No         | per week/ person | <b>15,00 €</b>  |
| <b>Beach towel</b> <i>(Payable in the base)</i><br><b>Price per week / Season: 2026 - Angelina Yachtcharter.</b> <i>Payable in the base</i>  | No         | per piece        | <b>10,00 €</b>  |
| <b>e-SUP</b> <i>(Payable in the base)</i><br><b>Price per week / Season: 2026 - Angelina Yachtcharter.</b> <i>SipaBoards - Allrounder; + additional deposit 500 EUR, order in advance due to limited quantity of equipment - Payable in the base</i> | No         | per week         | <b>270,00 €</b> |
| <b>eFoil</b> <i>(Payable in the base)</i><br><b>Price per week / Season: 2026 - Angelina Yachtcharter.</b> <i>For price and availability, please inquire. Additional deposit 3000€. - Payable in the base</i>  | No         | per booking      | <b>0,00 €</b>   |
| <b>Extra bedlinen</b> <i>(Payable in the base)</i><br><b>Price per week / Season: 2026 - Angelina Yachtcharter.</b> <i>Payable in the base</i>   | No         | per set          | <b>10,00 €</b>  |
| <b>Kayak</b> <i>(Payable in the base)</i><br><b>Price per week / Season: 2026 - Angelina Yachtcharter.</b> <i>*additional deposit 200 EUR with deposit insurance, order in advance due to limited quantity of equipment - Payable in the base</i>    | No         | per week         | <b>150,00 €</b> |
| <b>Outboard engine 5 HP</b> <i>(Payable in the base)</i><br><b>Price per week / Season: 2026 - Angelina Yachtcharter.</b> <i>Special promotion, free of charge - Payable in the base</i>   | No         | per booking      | <b>0,00 €</b>   |
| <b>Outboard engine 5 HP</b> <i>(Payable in the base)</i><br><b>Price per week / Season: 2026 - Angelina Yachtcharter.</b> <i>Special promotion, free of charge - Payable in the base</i>   | No         | per booking      | <b>0,00 €</b>   |

|  |    |             |                   |
|--|----|-------------|-------------------|
| <b>Outboard engine 5 HP</b> <i>(Payable in the base)</i>   | No | per week    | <b>140,00 €</b>   |
| <b>Price per week / Season: 2026 - Angelina Yachtcharter.</b> <i>Payable in the base</i>   |    |             |                   |
| <b>Railing net (Safety net)</b> <i>(Payable in the base)</i>   | No | per booking | <b>30,00 €</b>    |
| <b>Price per week / Season: 2026 - Angelina Yachtcharter.</b> <i>Rental without mounting; order in advance due to limited quantity of equipment - Payable in the base</i>                            |    |             |                   |
| <b>Railing net (Safety net)</b> <i>(Payable in the base)</i>   | No | per booking | <b>180,00 €</b>   |
| <b>Price per week / Season: 2026 - Angelina Yachtcharter.</b> <i>order in advance due to limited quantity of equipment - Payable in the base</i>   |    |             |                   |
| <b>Seabob</b> <i>(Payable in the base)</i>   | No | per week    | <b>1.050,00 €</b> |
| <b>Price per week / Season: 2026 - Angelina Yachtcharter.</b> <i>,For price and availability, please inquire.Additional deposit 1500€. - Payable in the base</i>                                     |    |             |                   |
| <b>Stand up paddle (SUP)</b> <i>(Payable in the base)</i>  | No | per week    | <b>100,00 €</b>   |
| <b>Price per week / Season: 2026 - Angelina Yachtcharter.</b> <i>*additional deposit 200 EUR with deposit insurance, order in advance due to limited quantity of equipment - Payable in the base</i> |    |             |                   |
| <b>Towels</b> <i>(Payable in the base)</i>   | No | per set     | <b>10,00 €</b>    |
| <b>Price per week / Season: 2026 - Angelina Yachtcharter.</b> <i>Payable in the base</i>   |    |             |                   |

## PRICE AND AVAILABILITY

|                                       |                                       |                                       |                                       |
|---------------------------------------|---------------------------------------|---------------------------------------|---------------------------------------|
| 13.09. - 20.09.2025<br>BOOKED         | 20.09. - 27.09.2025<br>BOOKED         | 27.09. - 04.10.2025<br>BOOKED         | 04.10. - 11.10.2025<br>2.201 € 2.445€ |
| 11.10. - 18.10.2025<br>BOOKED         | 18.10. - 25.10.2025<br>1.751 € 1.945€ | 25.10. - 01.11.2025<br>1.751 € 1.945€ | 01.11. - 08.11.2025<br>1.653 € 1.945€ |
| 10.11. - 31.12.2025<br>BOOKED         | 01.01. - 20.03.2026<br>BOOKED         | 21.03. - 28.03.2026<br>1.589 € 1.765€ | 28.03. - 04.04.2026<br>1.643 € 1.825€ |
| 04.04. - 11.04.2026<br>1.643 € 1.825€ | 11.04. - 18.04.2026<br>1.697 € 1.885€ | 18.04. - 25.04.2026<br>1.908 € 2.120€ | 25.04. - 02.05.2026<br>2.385 € 2.650€ |

## PRICE AND AVAILABILITY

|                                       |                                       |                                       |                                       |
|---------------------------------------|---------------------------------------|---------------------------------------|---------------------------------------|
| 02.05. - 09.05.2026<br>2.304 € 2.560€ | 09.05. - 16.05.2026<br>2.448 € 2.720€ | 16.05. - 23.05.2026<br>3.087 € 3.430€ | 23.05. - 30.05.2026<br>ON OPTION      |
| 30.05. - 06.06.2026<br>4.185 € 4.650€ | 06.06. - 13.06.2026<br>5.823 € 6.470€ | 13.06. - 20.06.2026<br>6.723 € 7.470€ | 20.06. - 27.06.2026<br>6.935 € 7.705€ |
| 27.06. - 04.07.2026<br>BOOKED         | 04.07. - 11.07.2026<br>5.922 € 6.580€ | 11.07. - 18.07.2026<br>6.372 € 7.080€ | 18.07. - 25.07.2026<br>5.922 € 6.580€ |
| 25.07. - 01.08.2026<br>ON OPTION      | 01.08. - 08.08.2026<br>7.731 € 8.590€ | 08.08. - 22.08.2026<br>BOOKED         | 22.08. - 29.08.2026<br>6.192 € 6.880€ |
| 29.08. - 05.09.2026<br>5.499 € 6.110€ | 05.09. - 12.09.2026<br>5.450 € 6.055€ | 12.09. - 19.09.2026<br>5.103 € 5.670€ | 19.09. - 26.09.2026<br>4.100 € 4.555€ |
| 26.09. - 03.10.2026<br>3.150 € 3.500€ | 03.10. - 10.10.2026<br>2.201 € 2.445€ | 10.10. - 17.10.2026<br>1.998 € 2.220€ | 17.10. - 24.10.2026<br>1.751 € 1.945€ |
| 24.10. - 31.10.2026<br>1.751 € 1.945€ | 31.10. - 07.11.2026<br>1.751 € 1.945€ | 07.11. - 14.11.2026<br>1.751 € 1.945€ | 15.11. - 31.12.2026<br>BOOKED         |