

# HANSE 588

Superstar (2017)

The Sailing yacht Hanse 588 Superstar homeport is Marina Mandalina, Sibenik, Croatia. Built in 2017, and accommodates up to 10 + 2 + 1 persons in 5 + 1 cabins, and has 3 heads.

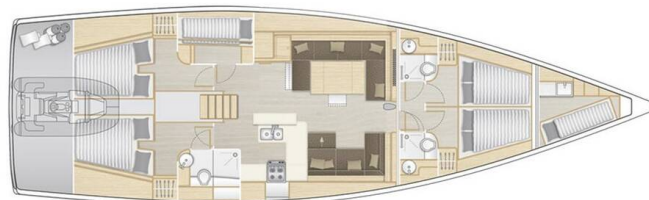

## YACHT SPECIFICATIONS

Charter base

**Marina Mandalina, Sibenik,  
Croatia**

Yacht ID

**7492**

Brands

**Hanse Yachts**

Name

**Superstar**

Production year

**2017**

Length

**56 ft**

Cabins

**5 + 1**

Berths

**10 + 2 + 1**

Max persons

**12**

Head/Shower

**3**

Engine

**1 x 110 HP**

Fuel tank

**520 l**

SECRET  ADRIATIC

### WEBSITE

[www.secret-adriatic.com](http://www.secret-adriatic.com)

### E-MAIL

[info@secret-adriatic.com](mailto:info@secret-adriatic.com)

### PHONE

+385 (0)91 2106 996

### SECRET ADRIATIC D.O.O.

Put Mavarčice 1/a, Okrug Gornji, Croatia

## YACHT EQUIPMENT

Additional	<b>Skipper's CV / sailing resume required upon booking confirmation</b>
Comfort	<b>Bed linen, Cockpit cushions, Sundeck cushions</b>
Deck	<b>Bimini top, Cockpit table, Cockpit/stern, outside shower, Dinghy, Electric anchor windlass, Gangway, Hydraulic lifting swimming platform, Sprayhood, Teak cockpit, Teak deck</b>
Entertainment	<b>Outdoor speakers, Radio CD player + USB, TV</b>
Galley	<b>Coffee machine, Freezer, Gas cookers, Hot water, Kitchen utensils (Galley equipment, cutlery), Oven, Refrigerator</b>
Interior	<b>Electric toilet</b>
Navigation	<b>Autopilot, Bow thruster, GPS chart plotter - cockpit, Navigation (Nautical) charts and nautical guide , Pilot book, Tridata</b>
Safety	<b>Set of tools , VHF radio</b>
Sails	<b>Electric primary winch</b>
Yacht electrics	<b>Air Conditioning, Battery charger , Generator, Heating, Inverter</b>

## SERVICES

EXTRA SERVICES	OBLIGATORY	PAYMENT TYPE	PRICE
<b>Charter pack</b> <i>(Payable in the base)</i> <b>Price per week / Season: 2025.</b> includes final cleaning, bedlinen, towels - 1 set/person, cooking gas	Yes	per booking	<b>410,00 €</b>
<b>Comfort Pack</b> <i>(Payable in the base)</i> <b>Price per week / Season: 2025.</b> Includes outboard 2,5 HP, Wi-Fi router. Applicable on charters with check-in date from 28.6.2025	No	per week	<b>105,00 €</b>
<b>Deposit insurance</b> <i>(Payable in the base)</i> <b>Price per week / Season: 2025.</b> + 450 EUR refundable deposit	No	per booking	<b>380,00 €</b>
<b>Early Check in</b> <i>(Payable in the base)</i> <b>Price per week / Season: 2025.</b> Saturdays between 13hr - 14hr. Early check in can be confirmed only on embarkation day in the charter base.	No	per booking	<b>250,00 €</b>
<b>Flexible booking</b> <i>(Payable in advance)</i> <b>Price per week / Season: 2025.</b> allows you to cancel or rebook your charter up to 30 days before the embarkation for no specific reason. You can reschedule your holiday at no cost for unlimited number of times or use a credit note if you are uncertain of new charter dates. With our FLEX PLAN your rebooking costs are completely eliminated while cancellation costs with refund option are reduced to a minimum (15% of the charter fee, min 350 EUR). Extra bonus: free cancellation and FULL REFUND granted in case of closed state borders within 7 days before the embarkation. Notes: FLEX PLAN costs 7% of the final charter price, can be added to booking up to 72hr after booking confirmation and is not available for bookings confirmed within 30 days before the embarkation.	No	per booking	<b>0,00 €</b>
<b>Hostess</b> <i>(Payable in advance)</i> <b>Price per week / Season: 2025.</b> + own cabin 50% cancellation fee in case of cancellation up to 15 days prior to embarkation 100% cancellation fee in case of cancellation within 14 days prior to embarkation	No	per day + food	<b>220,00 €</b>

<b>Late check out</b> (Payable in the base) <b>Price per week / Season: 2025.</b> Saturdays till 10hr Late check-out can be confirmed only on Friday before the embarkation day.	No	per booking	<b>350,00 €</b>
<b>One way fee</b> (Payable in the base) <b>Price per week / Season: 2025.</b> Ši - Bio / Bio - Ši On request only. One-way conditions: one way fee, skippers daily fee, berth charges in port of embarkation/disembarkation; check-out on Friday until 12:00 in Biograd	No	per booking	<b>250,00 €</b>
<b>One way fee</b> (Payable in the base) <b>Price per week / Season: 2025.</b> Ši - Kas / Kas - Ši On request only. One-way conditions: one way fee + skippers daily fee + berth charges in port of embarkation/disembarkation; check-out on Friday until 12:00 in Kaštela	No	per booking	<b>320,00 €</b>
<b>Outboard engine GRATIS</b> (Payable in the base) <b>Price per week / Season: 2025.</b> outboard engine 2,5 HP	Yes	per booking	<b>0,00 €</b>
<b>Pet on board</b> (Payable in the base) <b>Price per week / Season: 2025.</b> Small or medium pet, up to 25 kg	No	per booking	<b>150,00 €</b>
<b>Provisioning</b> (Payable in advance) <b>Price per week / Season: 2025.</b> upon request + price of groceries, to be done online	No	per booking	<b>0,00 €</b>
<b>Skipper</b> (Payable in advance) <b>Price per week / Season: 2025.</b> + own cabin 50% cancellation fee in case of cancellation up to 15 days prior to embarkation 100% cancellation fee in case of cancellation within 14 days prior to embarkation	No	per day + food	<b>240,00 €</b>

## OPTIONAL EXTRAS

EXTRAS	OBLIGATORY	PAYMENT TYPE	PRICE
<b>Beach towel</b> <i>(Payable in the base)</i> <b>Price per week / Season: 2025.</b> <i>Payable in the base</i>	No	per piece	<b>8,00 €</b>
<b>eFoil</b> <i>(Payable in advance)</i> <b>Price per week / Season: 2025.</b> <i>E-foil - Lift; + 130 EUR delivery fee; Refundable safety deposit 1000 EUR 50% cancellation fee in case of cancellation within 2 weeks prior to embarkation - Payable in advance</i>	No	per week	<b>2.000,00 €</b>
<b>Extra bedlinen</b> <i>(Payable in the base)</i> <b>Price per week / Season: 2025.</b> <i>Payable in the base</i>	No	per set	<b>15,00 €</b>
<b>Outboard engine 2,5 HP</b> <i>(Payable in the base)</i> <b>Price per week / Season: 2025.</b> <i>Payable in the base</i>	No	per week	<b>100,00 €</b>
<b>Outboard engine 5 HP</b> <i>(Payable in the base)</i> <b>Price per week / Season: 2025.</b> <i>on request - Payable in the base</i>	No	per week	<b>150,00 €</b>
<b>Railing net (Safety net)</b> <i>(Payable in the base)</i> <b>Price per week / Season: 2025.</b> <i>Rental without mounting - Payable in the base</i>	No	per booking	<b>20,00 €</b>
<b>Seabob</b> <i>(Payable in advance)</i> <b>Price per week / Season: 2025.</b> <i>Seabob F5; + 130 EUR delivery fee; Refundable safety deposit 500 EUR 50% cancellation fee in case of cancellation within 2 weeks prior to embarkation - Payable in advance</i>	No	per week	<b>1.200,00 €</b>
<b>Seabob 1</b> <i>(Payable in advance)</i> <b>Price per week / Season: 2025.</b> <i>Seabob F5s; + 130 EUR delivery fee; Refundable safety deposit 500 EUR 50% cancellation fee in case of cancellation within 2 weeks prior to embarkation - Payable in advance</i>	No	per week	<b>1.300,00 €</b>
<b>Seabob 1</b> <i>(Payable in advance)</i> <b>Price per week / Season: 2025.</b> <i>Seabob F5sr; + 130 EUR delivery fee; Refundable safety deposit 500 EUR 50% cancellation fee in case of cancellation within 2 weeks prior to embarkation - Payable in advance</i>	No	per week	<b>1.600,00 €</b>

<b>Snorkeling equipment</b> <i>(Payable in the base)</i>	No	per week	<b>10,00 €</b>
<b>Price per week / Season: 2025.</b> <i>Payable in the base</i>			
<b>Stand up paddle (SUP)</b> <i>(Payable in the base)</i>	No	per week	<b>120,00 €</b>
<b>Price per week / Season: 2025.</b> <i>Payable in the base</i>			
<b>Surf board</b> <i>(Payable in advance)</i>	No	per week	<b>2.000,00 €</b>
<b>Price per week / Season: 2025.</b> <i>Jetsurf; + 130 EUR delivery fee;</i>			
<i>Refundable safety deposit 1000 EUR 50% cancellation fee in case of cancellation within 2 weeks prior to embarkation - Payable in advance</i>			
<b>Towels</b> <i>(Payable in the base)</i>	No	per set	<b>8,00 €</b>
<b>Price per week / Season: 2025.</b> <i>2 psc/set (1 x 50x100cm + 1 x 70x140cm) - Payable in the base</i>			
<b>Wi-Fi Internet</b> <i>(Payable in the base)</i>	No	per week	<b>25,00 €</b>
<b>Price per week / Season: 2025.</b> <i>Payable in the base</i>			

## PRICE AND AVAILABILITY

19.07. - 26.07.2025 5.488 € 6.860€	26.07. - 02.08.2025 5.488 € 6.860€	02.08. - 09.08.2025 6.072 € 7.590€	09.08. - 23.08.2025 BOOKED
23.08. - 30.08.2025 BOOKED	30.08. - 06.09.2025 BOOKED	06.09. - 13.09.2025 5.424 € 6.780€	13.09. - 20.09.2025 BOOKED
20.09. - 27.09.2025 BOOKED	27.09. - 04.10.2025 BOOKED	04.10. - 18.10.2025 ON OPTION	18.10. - 25.10.2025 2.888 € 3.610€
25.10. - 01.11.2025 2.888 € 3.610€	01.11. - 08.11.2025 2.608 € 3.260€	08.11. - 15.11.2025 2.608 € 3.260€	15.11. - 22.11.2025 2.608 € 3.260€
22.11. - 29.11.2025 2.608 € 3.260€	29.11. - 06.12.2025 2.608 € 3.260€	06.12. - 13.12.2025 2.608 € 3.260€	13.12. - 20.12.2025 2.608 € 3.260€
20.12. - 27.12.2025 2.608 € 3.260€	03.01. - 10.01.2026 2.268 € 2.835€	10.01. - 17.01.2026 2.268 € 2.835€	17.01. - 24.01.2026 2.268 € 2.835€
24.01. - 31.01.2026 2.268 € 2.835€	31.01. - 07.02.2026 2.268 € 2.835€	07.02. - 14.02.2026 2.268 € 2.835€	14.02. - 21.02.2026 2.268 € 2.835€
21.02. - 28.02.2026 2.268 € 2.835€	28.02. - 07.03.2026 2.268 € 2.835€		

PRICE AND AVAILABILITY

07.03. - 14.03.2026	14.03. - 21.03.2026	21.03. - 26.12.2026
2.268 € 2.835€	2.268 € 2.835€	ON OPTION