

BAVARIA CRUISER 34 STYLE

Neo (2020)

The Sailing yacht Bavaria Cruiser 34 Style Neo homeport is Marina Zadar (ex. Tankerkomerc), Croatia. Built in 2020, and accommodates up to 6 + 2 persons in 3 cabins, and has 1 heads.

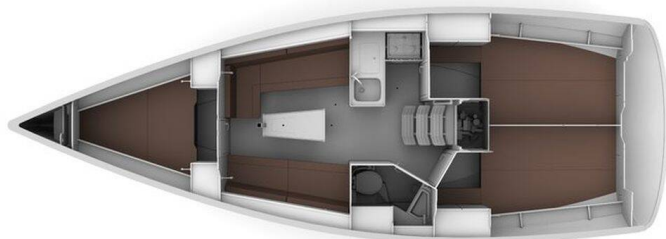

YACHT SPECIFICATIONS

Charter base

**Marina Zadar (ex.
Tankerkomerc), Croatia**

Yacht ID

3669

Brands

Bavaria Yachtbau

Name

Neo

Production year

2020

Length

33 ft

Cabins

3

Berths

6 + 2

Max persons

8

Head/Shower

1

Engine

1 x 30 HP

Fuel tank

150 l

SECRET  ADRIATIC

WEBSITE

www.secret-adriatic.com

E-MAIL

info@secret-adriatic.com

PHONE

+385 (0)91 2106 996

SECRET ADRIATIC D.O.O.

Put Mavarčice 1/a, Okrug Gornji, Croatia

YACHT EQUIPMENT

Comfort	Bed linen, Cockpit cushions
Deck	Anchor with chain, Bathing platform, Bimini top, Boat hook, Bosun's chair (Safe seat) (boatswain's chair), Cockpit table, Cockpit/stern, outside shower, Dinghy, Electric anchor windlass, Fenders, Gangway, Mooring ropes , Spare anchor (Reserve, Auxiliary anchor), Sprayhood, Swimming ladder, Teak cockpit, Water hose
Entertainment	Outdoor speakers, Radio, Sound System, TV, Underwater lights, Wi-Fi Internet
Galley	Freezer, Gas cookers, Hot water, Kitchen utensils (Galley equipment, cutlery), Oven, Refrigerator, Sink
Interior	Barometer, Clock, Electric toilet
Navigation	Autopilot, Binoculars, Bow thruster, Compass, Depthsounder, Divider, nautic chart, Echosounder/Depthsounder, Electronic sea charts, GPS chart plotter - cockpit, Hand bearing compass, Log, Nautical charts, Navigation (Nautical) charts and nautical guide , Navigation set, Navigation/position Lights, Pilot book, Radar reflector, Speedometer (Speed log), Wind instrument/Anemometer, Windex
Safety	Automatic Inflatable Life Jacket, Distress flare box, Engine spare parts , Fire axe, Fire extinguisher , First aid kit , Floating light, Horseshoe lifebuoy, Life belts (Safety harness), Life jackets, Liferaft , Safety equipment, Set of tools , Torch, VHF radio
Yacht electrics	220V socket, Air Conditioning, Battery charger , Bilge pump - Electric, Heating, Inverter, Shore power cable, Solar panels

SERVICES

EXTRA SERVICES	OBLIGATORY	PAYMENT TYPE	PRICE
Damage waiver <i>(Payable in the base)</i> Price per week / Season: 2026. - (reduces refundable security deposit to 100 EUR), per crew list 200 € by cash (does not cover missing fuel, loss of Tender, Outboarder or other Equipment)	No	per booking	300,00 €
Diver <i>(Payable in the base)</i> Price per week / Season: 2026. in case your check-out is at non-standard time	No	per booking	150,00 €
Early boarding/check-in <i>(Payable in the base)</i> Price per week / Season: 2026. at 13:00h, limited availability, up to 3 boats per Saturday! Subjected to availability!	No	per booking	150,00 €
Extra cleaning <i>(Payable in the base)</i> Price per week / Season: 2026.	No	per booking	240,00 €
Hostess <i>(Payable in the base)</i> Price per week / Season: 2026. Subject to availability	No	per week + food	1.400,00 €
Late check out <i>(Payable in the base)</i> Price per week / Season: 2026.	No	per booking	350,00 €
Overnight on board <i>(Payable in the base)</i> Price per week / Season: 2026. in base per night before or after your charter (if your boat is available)	No	per night	200,00 €
Pet on board <i>(Payable in the base)</i> Price per week / Season: 2026.	No	per booking	100,00 €
Re-booking fee <i>(Payable in the base)</i> Price per week / Season: 2026.	No	per booking	200,00 €
Skipper <i>(Payable in the base)</i> Price per week / Season: 2026. Subject to availability	No	per week + food	1.400,00 €

Transfer (Payable in the base)	No	one-way	35,00 €
Price per week / Season: 2026. (Airport Zadar to Bruneke Base) up to 3 persons. For other transport routes - price on request			
Transfer (Payable in the base)	No	one-way	45,00 €
Price per week / Season: 2026. (Airport Zadar to Bruneke Base) 4+ persons. For other transport routes - price on request.			
Transit log (Payable in the base)	Yes	per booking	320,00 €
Price per week / Season: 2026. Includes: Permit, end cleaning, bed linen (1 set/person) + medium towel (50x100cm), 2 x gas bottles, welcome pack, basic package for kitchen and toilets, FREE WIFI, dinghy & (outboard engine 2,5 HP - Honda + 5l fuel for outboard or electric outboard engine eLite 500W), one snorkeling set, check-in and out services, diver inspection in standard check out time			

OPTIONAL EXTRAS

EXTRAS	OBLIGATORY	PAYMENT TYPE	PRICE
Coolbox <i>(Payable in the base)</i> Price per week / Season: 2026. <i>Subjected to availability! - Payable in the base</i>	No	per week	50,00 €
Electric scooter <i>(Payable in the base)</i> Price per week / Season: 2026. <i>Subjected to availability! - Payable in the base</i>	No	per week	80,00 €
Extra bedlinen <i>(Payable in the base)</i> Price per week / Season: 2026. <i>Payable in the base</i>	No	per cabin	10,00 €
Extra towel - large <i>(Payable in the base)</i> Price per week / Season: 2026. <i>70x140cm - Payable in the base</i>	No	per piece	4,00 €
Gas bottles <i>(Payable in the base)</i> Price per week / Season: 2026. <i>extra - Payable in the base</i>	No	per piece	10,00 €
Generator <i>(Payable in the base)</i> Price per week / Season: 2026. <i>portable generator 3.5KV - Payable in the base</i>	No	per week	150,00 €
Grill/Barbecue/Plancha <i>(Payable in the base)</i> Price per week / Season: 2026. <i>Subjected to availability! - Payable in the base</i>	No	per week	50,00 €
Inflatable swimming platform <i>(Payable in the base)</i> Price per week / Season: 2026. <i>250x160cm Subjected to availability! - Payable in the base</i>	No	per week	100,00 €
Kayak <i>(Payable in the base)</i> Price per week / Season: 2026. <i>Subjected to availability! - Payable in the base</i>	No	per week	100,00 €
NESPRESSO coffee machine <i>(Payable in the base)</i> Price per week / Season: 2026. <i>capsules not included Subjected to availability! - Payable in the base</i>	No	per week	20,00 €

Railing net (Safety net) <i>(Payable in the base)</i>	No	per booking	100,00 €
Price per week / Season: 2026. <i>Subjected to availability! - Payable in the base</i>			
Snorkeling equipment <i>(Payable in the base)</i>	No	per week	10,00 €
Price per week / Season: 2026. <i>Payable in the base</i>			
Stand up paddle (SUP) <i>(Payable in the base)</i>	No	per week	50,00 €
Price per week / Season: 2026. <i>Payable in the base</i>			
Underwater scooter <i>(Payable in the base)</i>	No	per week	100,00 €
Price per week / Season: 2026. <i>Jobe Subjected to availability! - Payable in the base</i>			
Underwater scooter <i>(Payable in the base)</i>	No	per week	150,00 €
Price per week / Season: 2026. <i>Jobe PRO Subjected to availability! - Payable in the base</i>			
Wakeboard <i>(Payable in the base)</i>	No	per week	70,00 €
Price per week / Season: 2026. <i>Jobe Subjected to availability! - Payable in the base</i>			

PRICE AND AVAILABILITY

13.09. - 20.09.2025 BOOKED	20.09. - 27.09.2025 BOOKED	27.09. - 04.10.2025 BOOKED	04.10. - 11.10.2025 1.040 € 1.300 €
11.10. - 18.10.2025 960 € 1.200 €	19.10. - 31.12.2025 BOOKED	03.01. - 10.01.2026 1.100 €	10.01. - 17.01.2026 1.100 €
17.01. - 24.01.2026 1.100 €	24.01. - 31.01.2026 1.100 €	31.01. - 07.02.2026 1.100 €	07.02. - 14.02.2026 1.100 €
14.02. - 21.02.2026 1.100 €	21.02. - 28.02.2026 1.100 €	28.02. - 07.03.2026 1.100 €	07.03. - 14.03.2026 1.100 €
14.03. - 21.03.2026 1.100 €	21.03. - 28.03.2026 1.100 €	28.03. - 04.04.2026 1.100 €	04.04. - 11.04.2026 1.100 €
11.04. - 18.04.2026 1.100 €	18.04. - 25.04.2026 1.300 €	25.04. - 02.05.2026 1.400 €	

PRICE AND AVAILABILITY

02.05. - 09.05.2026 1.500 €	09.05. - 16.05.2026 1.700 €	16.05. - 23.05.2026 1.800 €	23.05. - 30.05.2026 2.000 €
30.05. - 06.06.2026 2.100 €	06.06. - 13.06.2026 2.200 €	13.06. - 20.06.2026 2.400 €	20.06. - 27.06.2026 2.600 €
27.06. - 04.07.2026 2.800 €	04.07. - 11.07.2026 2.900 €	11.07. - 18.07.2026 3.100 €	18.07. - 25.07.2026 3.200 €
25.07. - 01.08.2026 3.200 €	01.08. - 08.08.2026 3.100 €	08.08. - 15.08.2026 3.200 €	15.08. - 22.08.2026 3.100 €
22.08. - 29.08.2026 2.700 €	29.08. - 05.09.2026 2.400 €	05.09. - 12.09.2026 2.100 €	12.09. - 19.09.2026 2.100 €
19.09. - 26.09.2026 1.800 €	26.09. - 03.10.2026 1.400 €	03.10. - 10.10.2026 1.300 €	10.10. - 17.10.2026 1.100 €
17.10. - 24.10.2026 1.100 €	24.10. - 31.10.2026 1.100 €	31.10. - 07.11.2026 1.100 €	07.11. - 14.11.2026 1.100 €
14.11. - 21.11.2026 1.100 €	21.11. - 28.11.2026 1.100 €	28.11. - 05.12.2026 1.100 €	05.12. - 12.12.2026 1.100 €
12.12. - 19.12.2026 1.100 €	19.12. - 26.12.2026 1.100 €		