

# HANSE 458

Sarsala (2020)

The Sailing yacht Hanse 458 Sarsala homeport is Fethiye, Lykia Yacht Club, Turkey. Built in 2020, and accommodates up to 8 + 2 persons in 4 cabins, and has 2 heads.

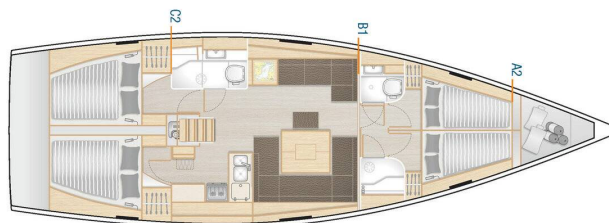
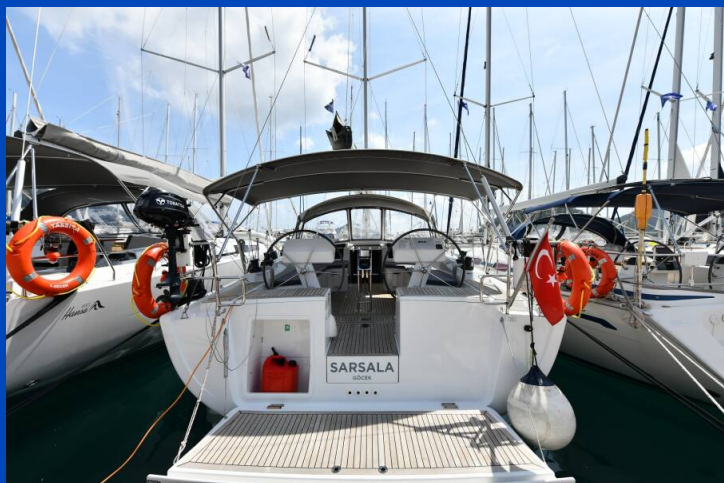

## YACHT SPECIFICATIONS

Charter base

**Fethiye, Lykia Yacht Club, Turkey**

Yacht ID

**3604**

Brands

**Hanse Yachts**

Name

**Sarsala**

Production year

**2020**

Length

**46 ft**

Cabins

**4**

Berths

**8 + 2**

Head/Shower

**2**

Engine

**1 x 57 HP**

Fuel tank

**210 l**

SECRET  ADRIATIC

WEBSITE

[www.secret-adriatic.com](http://www.secret-adriatic.com)

E-MAIL

[info@secret-adriatic.com](mailto:info@secret-adriatic.com)

PHONE

+385 (0)91 2106 996

SECRET ADRIATIC D.O.O.

Put Mavarčice 1/a, Okrug Gornji, Croatia

## YACHT EQUIPMENT

Deck	<b>Bathing platform, Bimini top, Cockpit table, Cockpit/stern, outside shower, Dinghy, Electric anchor windlass, Sprayhood, Teak cockpit</b>
Entertainment	<b>Outdoor speakers, Radio CD player</b>
Galley	<b>Gas cookers, Hot water, Kitchen utensils (Galley equipment, cutlery), Oven, Refrigerator</b>
Navigation	<b>Autopilot, Bow thruster, GPS chart plotter - cockpit, Nautical charts, Pilot book, Tridata</b>
Safety	<b>Set of tools , VHF radio</b>
Yacht electrics	<b>Battery charger , Heating, Inverter</b>

SERVICES

EXTRA SERVICES	OBLIGATORY	PAYMENT TYPE	PRICE
<b>Charter package</b> <i>(Payable in the base)</i> <b>Price per week / Season: 2025.</b> includes transit log, final cleaning, bedlinen, cooking gas, towels - 1 set p/p, 1 snorkeling set	Yes	per booking	<b>320,00 €</b>
<b>Comfort pack</b> <i>(Payable in the base)</i> <b>Price per week / Season: 2025.</b> outboard 3,5 HP, WiFi router, cockpit cushions	No	per week	<b>140,00 €</b>
<b>Comfort pack PREMIUM</b> <i>(Payable in the base)</i> <b>Price per week / Season: 2025.</b> includes outboard 3,5 hp, WiFi router, cockpit cushions, early check-in	No	per week	<b>290,00 €</b>
<b>Comfort pack XL</b> <i>(Payable in the base)</i> <b>Price per week / Season: 2025.</b> Includes: outboard 3,5 HP, WiFi router, beach towels, toiletries	No	per week	<b>200,00 €</b>
<b>Comfort pack XL PREMIUM</b> <i>(Payable in the base)</i> <b>Price per week / Season: 2025.</b> Includes: outboard 3,5 HP, WiFi router, beach towels, toiletries, early check-in	No	per week	<b>340,00 €</b>
<b>Early Check in</b> <i>(Payable in the base)</i> <b>Price per week / Season: 2025.</b> at 13:00hr ** Early check in can be confirmed only on embarkation day in the charter base.	No	per booking	<b>200,00 €</b>

<b>Flexible booking</b> (Payable in advance) <b>Price per week / Season: 2025.</b> allows you to cancel or rebook your charter up to 30 days before the embarkation for no specific reason. You can reschedule your holiday at no cost for unlimited number of times or use a credit note if you are uncertain of new charter dates. With our FLEX PLAN your rebooking costs are completely eliminated while cancellation costs with refund option are reduced to a minimum (15% of the charter fee, min 350 EUR). Extra bonus: free cancellation and FULL REFUND granted in case of closed state borders within 7 days before the embarkation. Notes: FLEX PLAN costs 10% of the final charter price, can be added to booking up to 72hr after booking confirmation and is not available for bookings confirmed within 30 days before the embarkation.	No	per booking	<b>0,00 €</b>
<b>Hostess</b> (Payable in the base) <b>Price per week / Season: 2025.</b> +food	No	per day	<b>130,00 €</b>
<b>Late check out</b> (Payable in the base) <b>Price per week / Season: 2025.</b> Saturdays till 10am	No	per booking	<b>350,00 €</b>
<b>One way</b> (Payable in the base) <b>Price per week / Season: 2025.</b> One way Fethiye – Marmaris, check-out on Friday until 12:00hr, ( berth charge in the port of disembarkation is not included in the fee and should be paid separately) Return at the base should be at least 1hour before disembarkation time	No	one-way	<b>390,00 €</b>
<b>One way</b> (Payable in the base) <b>Price per week / Season: 2025.</b> One way Fethiye – Kas , check-out on Friday until 12:00hr, ( berth charge in the port of disembarkation is not included in the fee and should be paid separately) Return at the base should be at least 1hour before disembarkation time	No	one-way	<b>390,00 €</b>
<b>One way</b> (Payable in the base) <b>Price per week / Season: 2025.</b> One way Fethiye – Bodrum, check-out on Friday until 09:00hr, ( berth charge in the port of disembarkation is not included in the fee and should be paid separately) Return at the base should be at least 1hour before disembarkation time	No	one-way	<b>590,00 €</b>
<b>Outboard engine</b> (Payable in the base) <b>Price per week / Season: 2025.</b> Gratis	Yes	per booking	<b>0,00 €</b>

<b>Pet on board</b> <i>(Payable in the base)</i>	No	per booking	<b>60,00 €</b>
<b>Price per week / Season: 2025.</b> <i>on request</i>			
<b>Regatta charge</b> <i>(Payable in the base)</i>	No	per booking	<b>400,00 €</b>
<b>Price per week / Season: 2025.</b>			
<b>Skipper</b> <i>(Payable in the base)</i>	No	per day + food	<b>170,00 €</b>
<b>Price per week / Season: 2025.</b>			
<b>Transit log</b> <i>(Payable in the base)</i>	No	per booking	<b>50,00 €</b>
<b>Price per week / Season: 2025.</b> <i>Obligatory charge for crew changes</i>			
<b>WI-FI Internet connection on boat</b> <i>(Payable in the base)</i>	No	per week	<b>70,00 €</b>
<b>Price per week / Season: 2025.</b> <i>unlimited</i>			

## OPTIONAL EXTRAS

EXTRAS	OBLIGATORY	PAYMENT TYPE	PRICE
<b>Beach towel</b> <i>(Payable in the base)</i> <b>Price per week / Season: 2025.</b> <i>Payable in the base</i>	No	per piece	<b>8,00 €</b>
<b>Bed linen</b> <i>(Payable in the base)</i> <b>Price per week / Season: 2025.</b> <i>Payable in the base</i>	No	per set	<b>10,00 €</b>
<b>Cockpit cushions</b> <i>(Payable in the base)</i> <b>Price per week / Season: 2025.</b> <i>Payable in the base</i>	No	per week	<b>30,00 €</b>
<b>Gennaker</b> <i>(Payable in the base)</i> <b>Price per week / Season: 2025.</b> <i>+ 750 EUR deposit raise - Payable in the base</i>	No	per week	<b>300,00 €</b>
<b>Railing net (Safety net)</b> <i>(Payable in the base)</i> <b>Price per week / Season: 2025.</b> <i>mounting/dismounting - Payable in the base</i>	No	per booking	<b>70,00 €</b>
<b>Stand up paddle (SUP)</b> <i>(Payable in the base)</i> <b>Price per week / Season: 2025.</b> <i>Payable in the base</i>	No	per week	<b>120,00 €</b>
<b>Sundeck cushions</b> <i>(Payable in the base)</i> <b>Price per week / Season: 2025.</b> <i>Payable in the base</i>	No	per week	<b>90,00 €</b>
<b>Towels</b> <i>(Payable in the base)</i> <b>Price per week / Season: 2025.</b> <i>2 pcs - Payable in the base</i>	No	per booking	<b>8,00 €</b>

## PRICE AND AVAILABILITY

19.07. - 26.07.2025 BOOKED	26.07. - 02.08.2025 2.992 € 3.740€	02.08. - 09.08.2025 3.072 € 3.840€	09.08. - 16.08.2025 BOOKED
16.08. - 23.08.2025 3.152 € 3.940€	23.08. - 30.08.2025 3.152 € 3.940€	30.08. - 06.09.2025 3.312 € 4.140€	06.09. - 13.09.2025 3.664 € 4.580€
13.09. - 20.09.2025 BOOKED	20.09. - 27.09.2025 BOOKED	27.09. - 04.10.2025 BOOKED	04.10. - 11.10.2025 BOOKED
11.10. - 18.10.2025 3.712 € 4.640€	18.10. - 25.10.2025 BOOKED	25.10. - 01.11.2025 BOOKED	01.11. - 08.11.2025 BOOKED
08.11. - 15.11.2025 2.912 € 3.640€	15.11. - 22.11.2025 2.512 € 3.140€	22.11. - 29.11.2025 2.512 € 3.140€	29.11. - 06.12.2025 2.512 € 3.140€
06.12. - 13.12.2025 2.512 € 3.140€	13.12. - 20.12.2025 2.512 € 3.140€	20.12. - 27.12.2025 2.512 € 3.140€	