

# AQUILA 42

This is It (2023)

The Power catamaran Aquila 42 This is It homeport is Bahamas, Abacos, Boat Harbour Marina, Bahamas. Built in 2023, and accommodates up to 6 persons in 3 cabins, and has 3 heads.

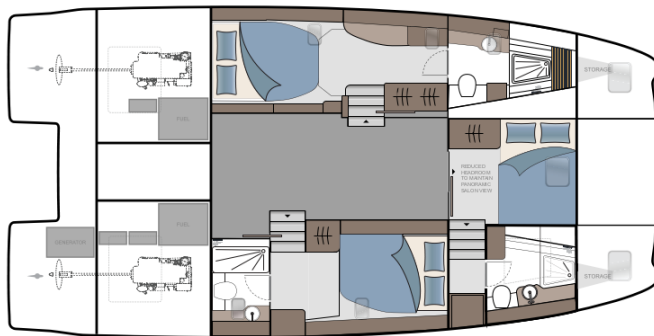

## YACHT SPECIFICATIONS

Charter base

**Bahamas, Abacos, Boat Harbour  
Marina, Bahamas**

Yacht ID

**16210**

Brands

**Aquila Yachts**

Name

**This is It**

Production year

**2023**

Length

**41 ft**

Cabins

**3**

Berths

**6**

Head/Shower

**3**

Engine

**2 x 0 HP**

Fuel tank

**1100 l**

SECRET  ADRIATIC

WEBSITE

[www.secret-adriatic.com](http://www.secret-adriatic.com)

E-MAIL

[info@secret-adriatic.com](mailto:info@secret-adriatic.com)

PHONE

+385 (0)91 2106 996

SECRET ADRIATIC D.O.O.

Put Mavarčice 1/a, Okrug Gornji, Croatia

## YACHT EQUIPMENT

Deck	<b>Bimini top, Cockpit fridge, Cockpit/stern, outside shower, Davit, Electric anchor windlass, Flybridge, Grill/Barbecue/Plancha</b>
Entertainment	<b>Indoor speakers, Outdoor speakers, Radio, Underwater lights</b>
Galley	<b>Freezer, Kitchen utensils (Galley equipment, cutlery), Microwave, Oven, Refrigerator, Stove</b>
Interior	<b>Electric toilet</b>
Navigation	<b>Autopilot, Depthsounder, GPS chart plotter - cockpit, Helm station</b>
Safety	<b>VHF radio</b>
Yacht electrics	<b>110V socket, Air Conditioning, Generator, Inverter, Shore power connection, Solar panels, USB sockets</b>

SERVICES

EXTRA SERVICES	OBLIGATORY	PAYMENT TYPE	PRICE
<b>ASA Processing Fee</b> <i>(Payable in advance)</i> <b>Price per week / Season: 2025.</b> Certificate 101	No	per person/per course	<b>150,00 €</b>
<b>ASA Processing Fee</b> <i>(Payable in advance)</i> <b>Price per week / Season: 2025.</b> Certificate 103	No	per person/per course	<b>150,00 €</b>
<b>ASA Processing Fee</b> <i>(Payable in advance)</i> <b>Price per week / Season: 2025.</b> Certificate 104	No	per person/per course	<b>200,00 €</b>
<b>ASA Processing Fee</b> <i>(Payable in advance)</i> <b>Price per week / Season: 2025.</b> Certificate 114	No	per person/per course	<b>200,00 €</b>
<b>ASA Processing Fee</b> <i>(Payable in advance)</i> <b>Price per week / Season: 2025.</b> Overnight Open Water. Available only on Flotilla Sails; Certificate 106	No	per person/per course	<b>250,00 €</b>
<b>ASA Processing Fee</b> <i>(Payable in advance)</i> <b>Price per week / Season: 2025.</b> Overnight Open Water. Available only on Flotilla Sails; Certificate 105	No	per person/per course	<b>400,00 €</b>
<b>ASA Processing Fee</b> <i>(Payable in advance)</i> <b>Price per week / Season: 2025.</b> Certificate 101, 103 & 104	No	per person/per course	<b>400,00 €</b>
<b>ASA Processing Fee</b> <i>(Payable in advance)</i> <b>Price per week / Season: 2025.</b> Overnight Open Water. Available only on Flotilla Sails; Certificate 105 & 106	No	per person/per course	<b>550,00 €</b>
<b>Bahamas foreign charter tax</b> <i>(Payable in advance)</i> <b>Price per week / Season: 2025.</b>	Yes	per booking	<b>0,00 €</b>
<b>Bahamas Taxes</b> <i>(Payable in advance)</i> <b>Price per week / Season: 2025.</b>	Yes	per booking	<b>0,00 €</b>
<b>Captain By Day</b> <i>(Payable in advance)</i> <b>Price per week / Season: 2025.</b>	No	per day + food	<b>350,00 €</b>

<b>Captain By Night</b> <i>(Payable in advance)</i> <b>Price per week / Season: 2025.</b>	No	per night	<b>450,00 €</b>
<b>Chef</b> <i>(Payable in advance)</i> <b>Price per week / Season: 2025.</b> Overnight	No	per day + food	<b>400,00 €</b>
<b>Daily trips</b> <i>(Payable in advance)</i> <b>Price per week / Season: 2025.</b> Trips north from Guana	No	per booking	<b>400,00 €</b>
<b>Delivery and pick up</b> <i>(Payable in the base)</i> <b>Price per week / Season: 2025.</b> Pick-up and drop-off in Little Harbour or Green Turtle Cay	No	one-way	<b>350,00 €</b>
<b>DRA</b> <i>(Payable in advance)</i> <b>Price per week / Season: 2025.</b>	Yes	per day	<b>50,00 €</b>
<b>Education</b> <i>(Payable in the base)</i> <b>Price per week / Season: 2025.</b> NauticEd skipper training hours	No	per person/per course	<b>100,00 €</b>
<b>Education</b> <i>(Payable in the base)</i> <b>Price per week / Season: 2025.</b> NauticEd bareboat hours	No	per person/per course	<b>200,00 €</b>
<b>Extra cleaning</b> <i>(Payable in the base)</i> <b>Price per week / Season: 2025.</b>	No	per service	<b>400,00 €</b>
<b>Fuel charge</b> <i>(Payable in advance)</i> <b>Price per week / Season: 2025.</b> + 500,00\$ deposit; This is only for power cat day trips	No	per booking	<b>300,00 €</b>
<b>Gratuity</b> <i>(Payable in advance)</i> <b>Price per week / Season: 2025.</b> On Day Trips	No	per booking	<b>220,00 €</b>
<b>Hostess/Cook</b> <i>(Payable in advance)</i> <b>Price per week / Season: 2025.</b>	No	per day + food	<b>350,00 €</b>
<b>Participation fee</b> <i>(Payable in the base)</i> <b>Price per week / Season: 2025.</b> NauticEd sign up fee	No	per person/per course	<b>175,00 €</b>
<b>Rescheduling</b> <i>(Payable in advance)</i> <b>Price per week / Season: 2025.</b> On Day Trips	No	per booking	<b>350,00 €</b>

<b>Sleep over after check out</b> <i>(Payable in advance)</i>	No	per booking	<b>700,00 €</b>
---------------------------------------------------------------	----	-------------	-----------------

**Price per week / Season: 2025.**

---

<b>Sleep over before check in</b> <i>(Payable in advance)</i>	No	per booking	<b>700,00 €</b>
---------------------------------------------------------------	----	-------------	-----------------

**Price per week / Season: 2025.** *at 3:00 PM*

## OPTIONAL EXTRAS

EXTRAS	OBLIGATORY	PAYMENT TYPE	PRICE
<b>Fins</b> <i>(Payable in advance)</i> <b>Price per week / Season: 2025.</b> <i>Payable in advance</i>	No	per week/ person	<b>35,00 €</b>
<b>Fishing cane/rod</b> <i>(Payable in advance)</i> <b>Price per week / Season: 2025.</b> <i>Payable in advance</i>	No	per week	<b>60,00 €</b>
<b>Inflatable swimming platform</b> <i>(Payable in advance)</i> <b>Price per week / Season: 2025.</b> <i>POP-UP DOCK - Payable in advance</i>	No	per week	<b>250,00 €</b>
<b>Kayak</b> <i>(Payable in advance)</i> <b>Price per week / Season: 2025.</b> <i>Tandem - Payable in advance</i>	No	per week	<b>250,00 €</b>
<b>Snorkeling equipment</b> <i>(Payable in advance)</i> <b>Price per week / Season: 2025.</b> <i>Payable in advance</i>	No	per week/ person	<b>50,00 €</b>
<b>Stand up paddle (SUP)</b> <i>(Payable in advance)</i> <b>Price per week / Season: 2025.</b> <i>Payable in advance</i>	No	per week	<b>250,00 €</b>
<b>Starlink</b> <i>(Payable in advance)</i> <b>Price per week / Season: 2025.</b> <i>Payable in advance</i>	No	per week	<b>100,00 €</b>