

EXCESS 11

Saint Andrew (2024)

The Catamaran Excess 11 Saint Andrew homeport is Corfu, Gouvia Marina, Greece. Built in 2024, and accommodates up to 8 + 1 + 1 persons in 4 + 1 cabins, and has 2 heads.

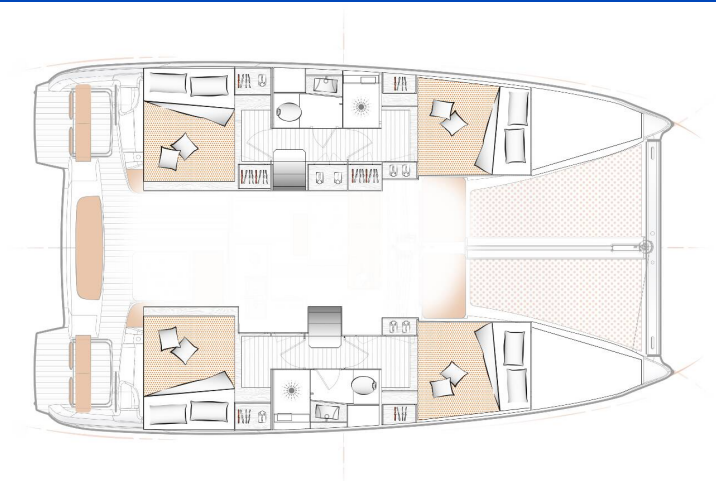

YACHT SPECIFICATIONS

Charter base	Yacht ID	Brands
Corfu, Gouvia Marina, Greece	14343	Excess
Name	Production year	Length
Saint Andrew	2024	37 ft
Cabins	Berths	
4 + 1	8 + 1 + 1	
Head/Shower	Engine	Fuel tank
2	2 x 29 HP	160 l

YACHT EQUIPMENT

Comfort	Bed linen, Cockpit cushions, Towels
Deck	Bimini top, Cockpit table, Cockpit/stern, outside shower, Dinghy, Gangway, Outboard engine, Sprayhood, Swimming ladder
Entertainment	Snorkeling equipment
Galley	Kitchen utensils (Galley equipment, cutlery), Refrigerator
Navigation	Autopilot, GPS chart plotter - cockpit
Safety	Life belts (Safety harness), Liferaft , VHF radio
Sails	Lazy jacks
Yacht electrics	Air Conditioning, Battery charger , Generator, Watermaker - desalinator

SERVICES

EXTRA SERVICES	OBLIGATORY	PAYMENT TYPE	PRICE
Cook <i>(Payable in the base)</i> Price per week / Season: 2026.	No	per day + food	220,00 €
Crew change <i>(Payable in the base)</i> Price per week / Season: 2026.	No	per booking	100,00 €
Damage waiver <i>(Payable in the base)</i> Price per week / Season: 2026. <i>plus security deposit 600€ *For Flotillas and Regattas, damage waiver is not applicable and normal security deposit depending on boat model must be applied.</i>	Yes	per booking	350,00 €
Early boarding/check-in <i>(Payable in the base)</i> Price per week / Season: 2026.	No	per booking	150,00 €
Final cleaning <i>(Payable in the base)</i> Price per week / Season: 2026.	Yes	per booking	280,00 €
Hostess <i>(Payable in the base)</i> Price per week / Season: 2026.	No	per day + food	190,00 €
Pet on board <i>(Payable in the base)</i> Price per week / Season: 2026. <i>double cleaning fee required</i>	No	per booking	0,00 €
Skipper <i>(Payable in the base)</i> Price per week / Season: 2026.	No	per day + food	210,00 €
Sunday Check-in <i>(Payable in the base)</i> Price per week / Season: 2026.	No	per booking	150,00 €
WI-FI Internet connection on boat <i>(Payable in the base)</i> Price per week / Season: 2026.	No	per week	100,00 €

SECRET  ADRIATIC

WEBSITE

www.secret-adriatic.com

E-MAIL

info@secret-adriatic.com

PHONE

+385 (0)91 2106 996

SECRET ADRIATIC D.O.O.

Put Mavarčice 1/a, Okrug Gornji, Croatia

OPTIONAL EXTRAS

EXTRAS	OBLIGATORY	PAYMENT TYPE	PRICE
Automatic Inflatable Life Jacket <i>(Payable in the base)</i> Price per week / Season: 2026. <i>not available in every base - Payable in the base</i>	No	per week/ person	20,00 €
Electric scooter <i>(Payable in the base)</i> Price per week / Season: 2026. <i>not available in every base - Payable in the base</i>	No	per week	150,00 €
Railing net (Safety net) <i>(Payable in the base)</i> Price per week / Season: 2026. <i>Payable in the base</i>	No	per booking	250,00 €
Stand up paddle (SUP) <i>(Payable in the base)</i> Price per week / Season: 2026. <i>Payable in the base</i>	No	per week	150,00 €

PRICE AND AVAILABILITY

03.01. - 10.01.2026 2.070 € 2.300€	10.01. - 17.01.2026 2.070 € 2.300€	17.01. - 24.01.2026 2.070 € 2.300€	24.01. - 31.01.2026 2.070 € 2.300€
31.01. - 07.02.2026 2.070 € 2.300€	07.02. - 14.02.2026 2.070 € 2.300€	14.02. - 21.02.2026 2.070 € 2.300€	21.02. - 28.02.2026 2.070 € 2.300€
28.02. - 07.03.2026 2.070 € 2.300€	07.03. - 14.03.2026 2.070 € 2.300€	14.03. - 21.03.2026 2.070 € 2.300€	21.03. - 28.03.2026 2.070 € 2.300€
28.03. - 04.04.2026 2.070 € 2.300€	04.04. - 11.04.2026 2.070 € 2.300€	11.04. - 18.04.2026 2.070 € 2.300€	18.04. - 25.04.2026 2.070 € 2.300€
25.04. - 02.05.2026 2.070 € 2.300€			

PRICE AND AVAILABILITY

02.05. - 09.05.2026 3.330 € 3.700-€	09.05. - 16.05.2026 3.330 € 3.700-€	16.05. - 23.05.2026 3.330 € 3.700-€	23.05. - 30.05.2026 3.330 € 3.700-€
30.05. - 06.06.2026 4.680 € 5.200-€	06.06. - 13.06.2026 4.680 € 5.200-€	13.06. - 20.06.2026 4.680 € 5.200-€	20.06. - 27.06.2026 5.580 € 6.200-€
27.06. - 04.07.2026 5.580 € 6.200-€	04.07. - 11.07.2026 5.580 € 6.200-€	11.07. - 18.07.2026 5.580 € 6.200-€	18.07. - 25.07.2026 5.580 € 6.200-€
25.07. - 01.08.2026 5.580 € 6.200-€	01.08. - 08.08.2026 6.750 € 7.500-€	08.08. - 15.08.2026 6.750 € 7.500-€	15.08. - 22.08.2026 6.750 € 7.500-€
22.08. - 29.08.2026 5.580 € 6.200-€	29.08. - 05.09.2026 5.580 € 6.200-€	05.09. - 12.09.2026 5.580 € 6.200-€	12.09. - 19.09.2026 4.680 € 5.200-€
19.09. - 26.09.2026 4.680 € 5.200-€	26.09. - 03.10.2026 3.510 € 3.900-€	03.10. - 10.10.2026 3.510 € 3.900-€	10.10. - 17.10.2026 3.510 € 3.900-€
17.10. - 24.10.2026 2.070 € 2.300-€	24.10. - 31.10.2026 2.070 € 2.300-€	31.10. - 07.11.2026 2.070 € 2.300-€	07.11. - 14.11.2026 2.070 € 2.300-€
14.11. - 21.11.2026 2.070 € 2.300-€	21.11. - 28.11.2026 2.070 € 2.300-€	28.11. - 05.12.2026 2.070 € 2.300-€	05.12. - 12.12.2026 2.070 € 2.300-€
12.12. - 19.12.2026 2.070 € 2.300-€	19.12. - 26.12.2026 2.070 € 2.300-€		