

# BALI 4.4

American Honey (2023)

The Catamaran Bali 4.4 American Honey homeport is Bahamas, Abacos, Boat Harbour Marina, Bahamas. Built in 2023, and accommodates up to 6 persons in 3 cabins, and has 3 heads.

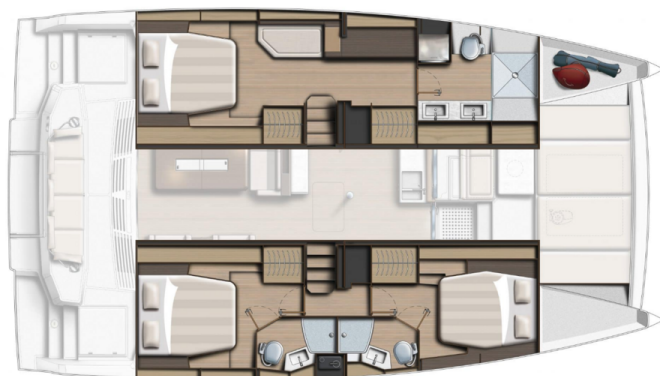

## YACHT SPECIFICATIONS

Charter base

**Bahamas, Abacos, Boat Harbour  
Marina, Bahamas**

Yacht ID

**12574**

Brands

**Catana Group**

Name

**American Honey**

Production year

**2023**

Length

**44 ft**

Cabins

**3**

Berths

**6**

Head/Shower

**3**

Engine

**2 x 57 HP**

Fuel tank

**800 l**

SECRET  ADRIATIC

### WEBSITE

[www.secret-adriatic.com](http://www.secret-adriatic.com)

### E-MAIL

[info@secret-adriatic.com](mailto:info@secret-adriatic.com)

### PHONE

+385 (0)91 2106 996

### SECRET ADRIATIC D.O.O.

Put Mavarčice 1/a, Okrug Gornji, Croatia

## YACHT EQUIPMENT

Comfort	Sundeck cushions
Deck	Cockpit table, Cockpit/stern, outside shower, Davit, Dinghy with outboard engine, Electric anchor windlass, Grill/Barbecue/Plancha, Sprayhood
Entertainment	Fusion radio, Indoor speakers, Outdoor speakers, Underwater lights
Galley	Freezer, Ice maker, Kitchen utensils (Galley equipment, cutlery), Microwave, Oven, Refrigerator, Stove
Interior	Electric toilet, Portable cooling fan
Navigation	Autopilot, GPS chart plotter - cockpit, Helm station, Wind/speed/depth instruments
Safety	VHF radio
Sails	Electric winch, Lazy bag, Lazy jacks
Yacht electrics	110V socket, Air Conditioning, Generator, Inverter, Shore power connection, Solar panels, USB sockets, Watermaker - desalinator

SERVICES

EXTRA SERVICES	OBLIGATORY	PAYMENT TYPE	PRICE
<b>ASA Processing Fee</b> <i>(Payable in advance)</i> <b>Price per week / Season: 2025.</b> Certificate 101	No	per person/per course	<b>150,00 €</b>
<b>ASA Processing Fee</b> <i>(Payable in advance)</i> <b>Price per week / Season: 2025.</b> Certificate 103	No	per person/per course	<b>150,00 €</b>
<b>ASA Processing Fee</b> <i>(Payable in advance)</i> <b>Price per week / Season: 2025.</b> Certificate 104	No	per person/per course	<b>200,00 €</b>
<b>ASA Processing Fee</b> <i>(Payable in advance)</i> <b>Price per week / Season: 2025.</b> Certificate 114	No	per person/per course	<b>200,00 €</b>
<b>ASA Processing Fee</b> <i>(Payable in advance)</i> <b>Price per week / Season: 2025.</b> Overnight Open Water. Available only on Flotilla Sails; Certificate 106	No	per person/per course	<b>250,00 €</b>
<b>ASA Processing Fee</b> <i>(Payable in advance)</i> <b>Price per week / Season: 2025.</b> Overnight Open Water. Available only on Flotilla Sails; Certificate 105	No	per person/per course	<b>400,00 €</b>
<b>ASA Processing Fee</b> <i>(Payable in advance)</i> <b>Price per week / Season: 2025.</b> Certificate 101, 103 & 104	No	per person/per course	<b>400,00 €</b>
<b>ASA Processing Fee</b> <i>(Payable in advance)</i> <b>Price per week / Season: 2025.</b> Overnight Open Water. Available only on Flotilla Sails; Certificate 105 & 106	No	per person/per course	<b>550,00 €</b>
<b>Bahamas foreign charter tax</b> <i>(Payable in advance)</i> <b>Price per week / Season: 2025.</b>	Yes	per booking	<b>0,00 €</b>
<b>Bahamas Taxes</b> <i>(Payable in advance)</i> <b>Price per week / Season: 2025.</b>	Yes	per booking	<b>0,00 €</b>
<b>Captain By Day</b> <i>(Payable in advance)</i> <b>Price per week / Season: 2025.</b>	No	per day + food	<b>350,00 €</b>

<b>Captain By Night</b> <i>(Payable in advance)</i> <b>Price per week / Season: 2025.</b>	No	per night	<b>450,00 €</b>
<b>Chef</b> <i>(Payable in advance)</i> <b>Price per week / Season: 2025. Overnight</b>	No	per day + food	<b>400,00 €</b>
<b>Daily trips</b> <i>(Payable in advance)</i> <b>Price per week / Season: 2025. Trips north from Guana</b>	No	per booking	<b>400,00 €</b>
<b>DRA</b> <i>(Payable in advance)</i> <b>Price per week / Season: 2025.</b>	Yes	per day	<b>50,00 €</b>
<b>Education</b> <i>(Payable in the base)</i> <b>Price per week / Season: 2025. NauticEd skipper training hours</b>	No	per person/per course	<b>100,00 €</b>
<b>Education</b> <i>(Payable in the base)</i> <b>Price per week / Season: 2025. NauticEd bareboat hours</b>	No	per person/per course	<b>200,00 €</b>
<b>Extra cleaning</b> <i>(Payable in the base)</i> <b>Price per week / Season: 2025.</b>	No	per service	<b>400,00 €</b>
<b>Fuel charge</b> <i>(Payable in advance)</i> <b>Price per week / Season: 2025. + 500,00\$ deposit; This is only for day trips</b>	No	per booking	<b>300,00 €</b>
<b>Gratuity</b> <i>(Payable in advance)</i> <b>Price per week / Season: 2025. On Day Trips</b>	No	per booking	<b>220,00 €</b>
<b>Hostess/Cook</b> <i>(Payable in advance)</i> <b>Price per week / Season: 2025.</b>	No	per day + food	<b>350,00 €</b>
<b>Participation fee</b> <i>(Payable in the base)</i> <b>Price per week / Season: 2025. NauticEd sign up fee</b>	No	per person/per course	<b>175,00 €</b>
<b>Rescheduling</b> <i>(Payable in advance)</i> <b>Price per week / Season: 2025. On Day Trips</b>	No	per booking	<b>350,00 €</b>
<b>Sleep over after check out</b> <i>(Payable in advance)</i> <b>Price per week / Season: 2025.</b>	No	per booking	<b>700,00 €</b>
<b>Sleep over before check in</b> <i>(Payable in advance)</i> <b>Price per week / Season: 2025. at 3:00 PM</b>	No	per booking	<b>700,00 €</b>

**SECRET ADRIATIC**

**WEBSITE**

www.secret-adriatic.com

**PHONE**

+385 (0)91 2106 996

**E-MAIL**

info@secret-adriatic.com

**SECRET ADRIATIC D.O.O.**

Put Mavarčice 1/a, Okrug Gornji, Croatia

## OPTIONAL EXTRAS

EXTRAS	OBLIGATORY	PAYMENT TYPE	PRICE
<b>Fins</b> <i>(Payable in advance)</i> <b>Price per week / Season: 2025.</b> <i>Payable in advance</i>	No	per week/ person	<b>35,00 €</b>
<b>Fishing cane/rod</b> <i>(Payable in advance)</i> <b>Price per week / Season: 2025.</b> <i>Payable in advance</i>	No	per week	<b>60,00 €</b>
<b>Inflatable swimming platform</b> <i>(Payable in advance)</i> <b>Price per week / Season: 2025.</b> <i>POP-UP DOCK - Payable in advance</i>	No	per week	<b>250,00 €</b>
<b>Kayak</b> <i>(Payable in advance)</i> <b>Price per week / Season: 2025.</b> <i>Tandem - Payable in advance</i>	No	per week	<b>250,00 €</b>
<b>Snorkeling equipment</b> <i>(Payable in advance)</i> <b>Price per week / Season: 2025.</b> <i>Payable in advance</i>	No	per week/ person	<b>50,00 €</b>
<b>Stand up paddle (SUP)</b> <i>(Payable in advance)</i> <b>Price per week / Season: 2025.</b> <i>Payable in advance</i>	No	per week	<b>250,00 €</b>
<b>Starlink</b> <i>(Payable in advance)</i> <b>Price per week / Season: 2025.</b> <i>Payable in advance</i>	No	per week	<b>100,00 €</b>