

OCEANIS 51.1

Dima II (2018)

The Sailing yacht Oceanis 51.1 Dima II homeport is Corfu, Gouvia Marina, Greece. Built in 2018, and accommodates up to 10 + 2 persons in 5 cabins, and has 3 + 1 heads.

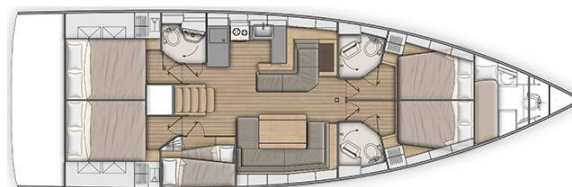

YACHT SPECIFICATIONS

Charter base

Corfu, Gouvia Marina, Greece

Yacht ID

12340

Brands

Bénétteau

Name

Dima II

Production year

2018

Length

52 ft

Cabins

5

Berths

10 + 2

Max persons

12

Head/Shower

3 + 1

Engine

1 x 110 HP

Fuel tank

400 l

SECRET  ADRIATIC

WEBSITE

www.secret-adriatic.com

E-MAIL

info@secret-adriatic.com

PHONE

+385 (0)91 2106 996

SECRET ADRIATIC D.O.O.

Put Mavarčice 1/a, Okrug Gornji, Croatia

YACHT EQUIPMENT

| | |
|-----------------|--|
| Comfort | Cockpit cushions |
| Deck | Bimini top, Cockpit table, Cockpit/stern, outside shower, Davit, Dinghy, Electric anchor windlass, Gangway, Remote control for anchor winch with chain counter at helm, Sprayhood, Swimming ladder |
| Entertainment | Fusion radio, Outdoor speakers, Radio, USB, Bluetooth, Snorkeling equipment |
| Galley | Freezer, Kitchen utensils (Galley equipment, cutlery), Microwave, Oven, Refrigerator, Stove |
| Interior | Convertible table in salon, Electric fans in cabins, Electric toilet |
| Navigation | Autopilot, Bow thruster, Echosounder/Depthsounder, GPS chart plotter - cockpit, List of lights, Nautical charts, Navigation set, Pilot book, Speedometer (Speed log), Wind instrument/Anemometer |
| Safety | VHF radio |
| Sails | Electric winch, Lazy bag, Lazy jacks, Self tailing Genoa |
| Yacht electrics | Battery charger , Inverter, Plug 220V, 12 V, Solar panels, WC pump |

SERVICES

| EXTRA SERVICES | OBLIGATORY | PAYMENT TYPE | PRICE |
|---|------------|-----------------|-----------------|
| Charter package <i>(Payable in the base)</i> Price per week / Season: 2026. End Cleaning, Outboard Engine, Dinghy, 1x set of Bed Linen & Bath Towels/person, 1x bottle of local wine, sparkling water, 1 bottle of Gas, local Greek nuts & marmalade, bathroom amenities, rubbish bags, welcome card. | Yes | per booking | 350,00 € |
| Cook <i>(Payable in the base)</i> Price per week / Season: 2026. Paid on spot in cash. Food provided by clients or to be paid an extra 30€/day. Cook must have his own cabin and access to one of the toilets. | No | per day + food | 210,00 € |
| Crew change <i>(Payable in the base)</i> Price per week / Season: 2026. Crew change includes administration fee, change of bed linen & towels and one night at Ionian Catamarans' pontoon. It doesn't include end cleaning. | No | per crew change | 100,00 € |
| Damage waiver <i>(Payable in the base)</i> Price per week / Season: 2026. non refundable; + 750,00EUR refundable; Damage waiver is obligatory on Skippered charters. Payable on spot in cash. Minimum charge is 7 days. | No | per week | 490,00 € |
| Early Check in <i>(Payable in the base)</i> Price per week / Season: 2026. embarkation starting by 2PM | No | per booking | 180,00 € |
| Hostess <i>(Payable in the base)</i> Price per week / Season: 2026. Food provided by clients or to be paid an extra 30€/day. Hostess Duties: Taking care of deck works, skipper assistance, cleaning of common areas, i.e. saloon, galley, prepare breakfast and a light lunch daily; Paid on spot in cash + food provisioning on client's burden. Hostess must have her own cabin and access to one of the toilets. | No | per day + food | 190,00 € |
| Provisioning <i>(Payable in the base)</i> Price per week / Season: 2026. order form will be forwarded upon request. Please fill it in and email it back to us, at least 3 days before embarkation. Upon your arrival your food and drinks will be onboard | No | per booking | 0,00 € |

| | | | |
|---|----|----------------|-----------------|
| Skipper <i>(Payable in the base)</i> | No | per day + food | 210,00 € |
| Price per week / Season: 2026. Paid on spot in cash. Food provided by clients or to be paid an extra 30€/day. Skipper must have his own cabin and access to one of the toilets. Damage waiver is obligatory on skippered charters. | | | |
| Starter pack <i>(Payable in the base)</i> | No | per booking | 70,00 € |
| Price per week / Season: 2026. dishwash liquid, sponge, rubbish bags, matches, toilet & kitchen rolls, fruit plate, water, orange juice, wine, packet of biscuits, individual sachets of tea, coffee, sugar, milk. | | | |
| Transfer <i>(Payable in the base)</i> | No | one-way | 0,00 € |
| Price per week / Season: 2026. from airport to marina and vice versa, rates upon request (can only be arranged the latest 3 days before embarkation) | | | |
| WI-FI Internet connection on boat <i>(Payable in the base)</i> | No | per week | 70,00 € |
| Price per week / Season: 2026. 10GB, on request | | | |

OPTIONAL EXTRAS

| EXTRAS | OBLIGATORY | PAYMENT TYPE | PRICE |
|--|------------|--------------|-----------------|
| Extra bedlinen <i>(Payable in the base)</i> Price per week / Season: 2026. <i>Payable in the base</i> | No | per set | 15,00 € |
| Extra towels <i>(Payable in the base)</i> Price per week / Season: 2026. <i>Payable in the base</i> | No | per piece | 10,00 € |
| Fishing cane/rod <i>(Payable in the base)</i> Price per week / Season: 2026. <i>Payable in the base</i> | No | per week | 80,00 € |
| Grill/Barbecue/Plancha <i>(Payable in the base)</i> Price per week / Season: 2026. <i>electric - Payable in the base</i> | No | per week | 80,00 € |
| Grill/Barbecue/Plancha <i>(Payable in the base)</i> Price per week / Season: 2026. <i>small - Payable in the base</i> | No | per week | 100,00 € |
| Grill/Barbecue/Plancha <i>(Payable in the base)</i> Price per week / Season: 2026. <i>big - Payable in the base</i> | No | per week | 120,00 € |
| Kayak <i>(Payable in the base)</i> Price per week / Season: 2026. <i>Payable in the base</i> | No | per week | 100,00 € |
| Railing net (Safety net) <i>(Payable in the base)</i> Price per week / Season: 2026. <i>just provided, not installed! - Payable in the base</i> | No | per booking | 240,00 € |
| Sea Scooter <i>(Payable in the base)</i> Price per week / Season: 2026. <i>+ extra security deposit Euro 750 (refundable) - Payable in the base</i> | No | per week | 320,00 € |
| Stand up paddle (SUP) <i>(Payable in the base)</i> Price per week / Season: 2026. <i>Payable in the base</i> | No | per week | 120,00 € |

PRICE AND AVAILABILITY

| | | | |
|---------------------------------------|---------------------------------------|---------------------------------------|---------------------------------------|
| 13.09. - 27.09.2025 BOOKED | 27.09. - 04.10.2025 BOOKED | 04.10. - 11.10.2025 BOOKED | 11.10. - 18.10.2025 BOOKED |
| 18.10. - 25.10.2025 2.025 € 2.700€ | 25.10. - 01.11.2025 BOOKED | 01.11. - 08.11.2025 2.025 € 2.700€ | 08.11. - 15.11.2025 2.025 € 2.700€ |
| 15.11. - 22.11.2025 2.025 € 2.700€ | 22.11. - 29.11.2025 2.025 € 2.700€ | 29.11. - 06.12.2025 2.025 € 2.700€ | 06.12. - 13.12.2025 2.025 € 2.700€ |
| 13.12. - 20.12.2025 2.025 € 2.700€ | 20.12. - 27.12.2025 2.025 € 2.700€ | 03.01. - 10.01.2026 2.349 € 2.900€ | 10.01. - 17.01.2026 2.349 € 2.900€ |
| 17.01. - 24.01.2026 2.349 € 2.900€ | 24.01. - 31.01.2026 2.349 € 2.900€ | 31.01. - 07.02.2026 2.349 € 2.900€ | 07.02. - 14.02.2026 2.349 € 2.900€ |
| 14.02. - 21.02.2026 2.349 € 2.900€ | 21.02. - 28.02.2026 2.349 € 2.900€ | 28.02. - 07.03.2026 2.349 € 2.900€ | 07.03. - 14.03.2026 2.349 € 2.900€ |
| 14.03. - 21.03.2026 2.349 € 2.900€ | 21.03. - 28.03.2026 2.349 € 2.900€ | 28.03. - 04.04.2026 2.349 € 2.900€ | 04.04. - 11.04.2026 2.349 € 2.900€ |
| 11.04. - 18.04.2026 2.349 € 2.900€ | 18.04. - 25.04.2026 3.078 € 3.800€ | 25.04. - 02.05.2026 3.078 € 3.800€ | |

PRICE AND AVAILABILITY

| | | | |
|--|--|--|--|
| 02.05. - 09.05.2026 3.078 € 3.800-€ | 09.05. - 16.05.2026 3.078 € 3.800-€ | 16.05. - 23.05.2026 3.078 € 3.800-€ | 23.05. - 30.05.2026 4.860 € 5.400-€ |
| 30.05. - 06.06.2026 4.860 € 5.400-€ | 06.06. - 13.06.2026 4.860 € 5.400-€ | 13.06. - 20.06.2026 5.760 € 6.400-€ | 20.06. - 27.06.2026 5.760 € 6.400-€ |
| 27.06. - 04.07.2026 5.760 € 6.400-€ | 04.07. - 11.07.2026 5.760 € 6.400-€ | 11.07. - 18.07.2026 5.760 € 6.400-€ | 18.07. - 25.07.2026 5.760 € 6.400-€ |
| 25.07. - 01.08.2026 7.200 € 8.000-€ | 01.08. - 08.08.2026 7.200 € 8.000-€ | 08.08. - 15.08.2026 7.200 € 8.000-€ | 15.08. - 22.08.2026 5.760 € 6.400-€ |
| 22.08. - 29.08.2026 5.760 € 6.400-€ | 29.08. - 05.09.2026 5.760 € 6.400-€ | 05.09. - 12.09.2026 5.760 € 6.400-€ | 12.09. - 19.09.2026 4.860 € 5.400-€ |
| 19.09. - 26.09.2026 4.860 € 5.400-€ | 26.09. - 03.10.2026 4.860 € 5.400-€ | 03.10. - 10.10.2026 3.420 € 3.800-€ | 10.10. - 17.10.2026 3.420 € 3.800-€ |
| 17.10. - 24.10.2026 2.610 € 2.900-€ | 24.10. - 31.10.2026 2.610 € 2.900-€ | 31.10. - 07.11.2026 2.610 € 2.900-€ | 07.11. - 14.11.2026 2.610 € 2.900-€ |
| 14.11. - 21.11.2026 2.610 € 2.900-€ | 21.11. - 28.11.2026 2.610 € 2.900-€ | 28.11. - 05.12.2026 2.610 € 2.900-€ | 05.12. - 12.12.2026 2.610 € 2.900-€ |
| 12.12. - 19.12.2026 2.610 € 2.900-€ | 19.12. - 26.12.2026 2.610 € 2.900-€ | | |