

BAVARIA CRUISER 40

Sylvia (2013)

The Sailing yacht Bavaria Cruiser 40 Sylvia homeport is Preveza, Main Port, Greece. Built in 2013, and accommodates up to 6 + 1 persons in 3 cabins, and has 2 heads.

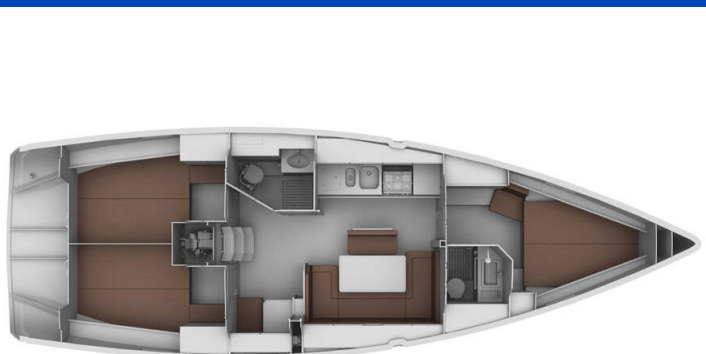

YACHT SPECIFICATIONS

Charter base

Preveza, Main Port, Greece

Yacht ID

11499

Brands

Bavaria Yachtbau

Name

Sylvia

Production year

2013

Length

41 ft

Cabins

3

Berths

6 + 1

Head/Shower

2

Engine

1 x 40 HP

Fuel tank

210 l

SECRET  ADRIATIC

WEBSITE

www.secret-adriatic.com

E-MAIL

info@secret-adriatic.com

PHONE

+385 (0)91 2106 996

SECRET ADRIATIC D.O.O.

Put Mavarčice 1/a, Okrug Gornji, Croatia

YACHT EQUIPMENT

Deck	Bimini top, Electric anchor windlass, Gangway, Hydraulic lifting swimming platform, Mooring ropes , Repair box for dinghy, Reserve motor oil, Sprayhood
Entertainment	Radio CD mp3 player
Interior	Electric fans in cabins, Electric toilet
Navigation	Autopilot, Bow thruster, Echosounder/Depthsounder, GPS chart plotter - cockpit, Speedometer (Speed log), Wind instrument/Anemometer
Safety	Repair kit, VHF radio
Yacht electrics	Inverter, Service batteries, Solar panels, Start battery

SERVICES

EXTRA SERVICES	OBLIGATORY	PAYMENT TYPE	PRICE
----------------	------------	--------------	-------

OPTIONAL EXTRAS

EXTRAS	OBLIGATORY	PAYMENT TYPE	PRICE
--------	------------	--------------	-------

PRICE AND AVAILABILITY

06.09. - 13.09.2025 BOOKED	13.09. - 20.09.2025 2.475 € 3.300€	20.09. - 04.10.2025 BOOKED	04.10. - 11.10.2025 1.911 € 2.450€
11.10. - 18.10.2025 1.911 € 2.450€	18.10. - 25.10.2025 1.665 € 1.850€	25.10. - 01.11.2025 1.665 € 1.850€	01.11. - 08.11.2025 1.665 € 1.850€
15.11. - 31.12.2025 BOOKED			